

SOLD



RE/MAX Coast



**129 Mildura Drive, Helensvale**

We have clear instructions by our vendor to present all serious offers. The owners of this beautiful family home have bought elsewhere and need to sell. This single level on a large (low maintenance) 800m2 block, this family entertainer is a must to inspect. With extensive outdoor entertaining, the sunny north-east facing backyard will be centre stage this summer with a large fenced pool plus two separate covered alfresco areas to enjoy. Inside, the floor plan will delight with 5 bedrooms and two separate internal living zones there is plenty of space to be found and the REAL polished timber floors add beauty and warmth to the home. Just 5 minutes drive from Westfield, train (to Brisbane CBD) and the G:Link light rail this wonderfully maintained property could be your happy home or a clever investment. ...

...

4 1 2

**Price:** \$990,000  
**View:** <https://remaxcoast.com.au/7859366>

**Kevin Brown**  
**M 0417648001**



**Neil Cooper**  
**0435806009**  
 RE/MAX Coast



**LEGEND**

- 1. Driveway Parking | 2. Double Carport
- 3. Entry Porch | 4. Side Gate Access
- 5. Water Tank | 6. Poolside Patio
- 7. Swimming Pool | 8. Open-Air Patio
- 9. Entertaining Deck | 10. Fenced Grass Yard
- 11. Garden Shed (3.0 x 3.0)



MILDURA DRIVE

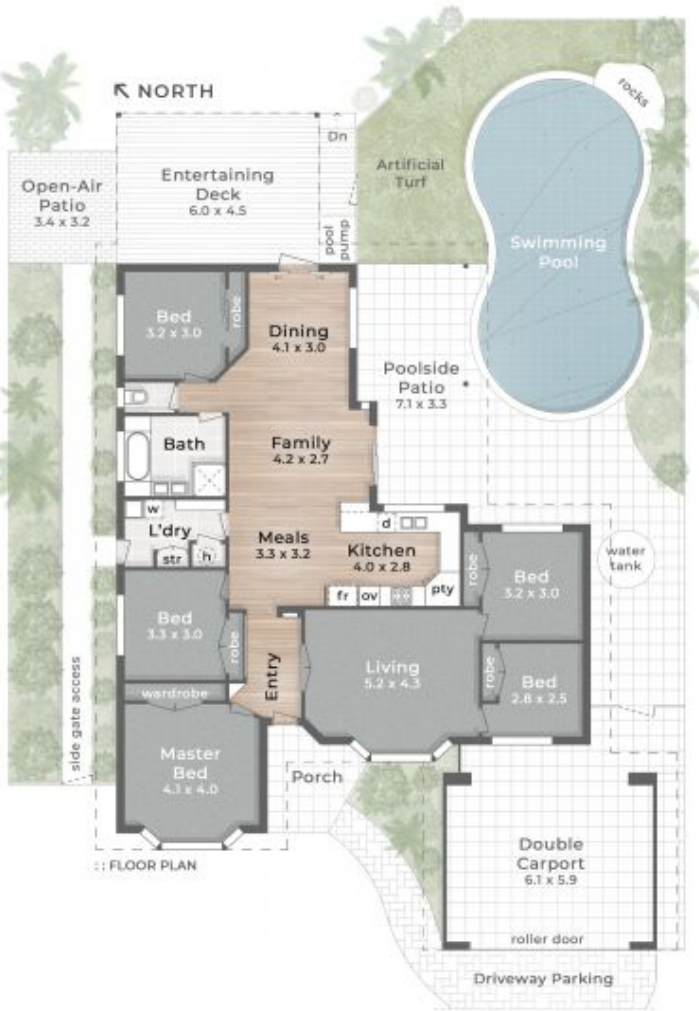

FLOOR PLAN

129 Mildura Drive  
HELENSVALE

- 800m<sup>2</sup>
- 5 Bed
- 1 Bath
- 2 Car + Off-Street

Internal 164m<sup>2</sup>  
Porch, Patios & Deck 66m<sup>2</sup>  
Carport 38m<sup>2</sup>  
Total 268m<sup>2</sup>

**pdc.**

This is not a legal document therefore all measurements and information provided is subject to survey. No permission is given to use or alter this Floor Plan without the consent of Pure Design Concepts. The overall presentation style, layout, imagery, font, background, colours and terminology has been originally created by PDC and is subject to strict copyright. No ownership is taken of building design. Find out more at [puredesignconcepts.com.au](http://puredesignconcepts.com.au)