

SOLD

2/15 Parkridge Drive, Molendinar

With delightful outdoor entertaining plus gardens backing on to a nature reserve, this beautifully maintained town home is a surprise package indeed. Currently owner occupied with nothing to spend, it's ideal for small families, couples, or investors looking for unbeatable value at an affordable price point. Situated within a boutique complex of only 5 lots, the property boasts open plan living that spills out to one of the largest outdoor allotments we've seen (for a property of this type). A standout feature is its backyard and gardens providing a private and tranquil space to relax and unwind. Whether hosting a BBQ, or growing your own veggies, you will appreciate the privacy, natural light and serene bush outlook. Fully fenced, the rear level grass area is ideal for your pet or morning yoga routine. ...

Inside, you will be impressed with open plan living plus A/C and fans. For its size, this floor plan packs a punch and has everything you could need. Situated in a sought-after Gold

2 1 1

Price: \$506,000

View: <https://remaxcoast.com.au/7784730>

Kevin Brown
M 0417648001



Elisa Rooney

0475037943
RE/MAX Coast



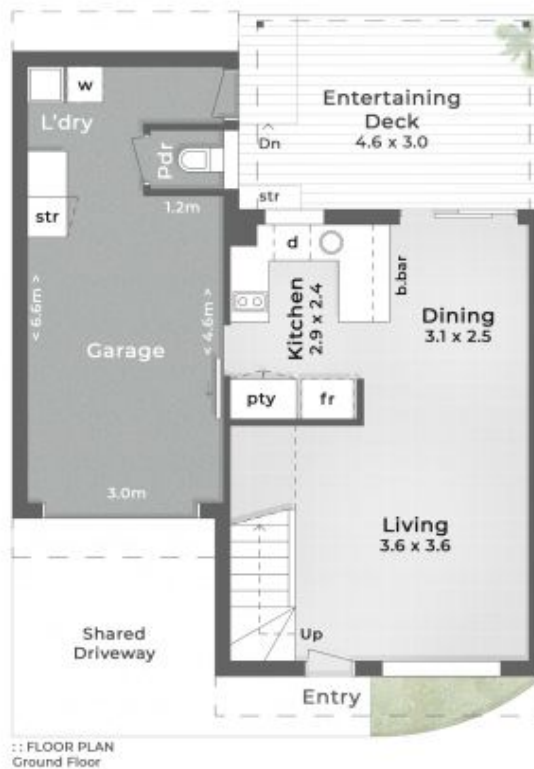

- LEGEND**
1. Shared Driveway
 2. Entry
 3. Entertaining Deck
 4. Garden Shed (2.1 x 1.5)
 5. Grass Yard
 6. Clothes Line
 7. Veggie Gardens



DRIVEWAY ACCESS TO
PARKRIDGE DRIVE

DAVIES PLACE 2/15 Parkridge Drive MOLENDINAR

RE/MAX
Coast

Kevin Brown 0417 648 001

2 Bed 1 Bath + Powder 1 Car

Internal 90m² | Decks 24m² | Total 114m²

This is not a legal document therefore all measurements and information provided is subject to survey. No permission is given to use or alter this Floor Plan without the consent of Pure Design Concepts. The overall presentation style, layout, imagery, fonts, background, colours and terminology has been originally created by PDC and is subject to strict copyright. No ownership is taken of building design. Find out more at puredesignconcepts.com.au

pdc.