

SOLD



4/141 Cotlew Street, Ashmore

Located at the rear of a secure gated complex of just 16, this beautiful and spacious townhome offers lifestyle and location. Diagonally opposite Ashmore Plaza (supermarket / chemist / cafe) this is a location where a car is not essential. That said, it offers parking for three!

Inside you will find a generous 20 square floor plan with sunny outdoor areas and two upper balconies. A lower living area and upper study nook provide practical spaces for all household members and with luxuries like stone benches, walk in robe and huge spa bath you will really enjoy living here.

FEATURES:

- 3 Bathrooms (all with built-in-robos and fans)...

...

3 2 3

Price: \$640,500

View: <https://remaxcoast.com.au/7572074>

Kevin Brown
M 0417648001



RE/MAX Coast

GROUND FLOOR

FIRST FLOOR

SITE PLAN

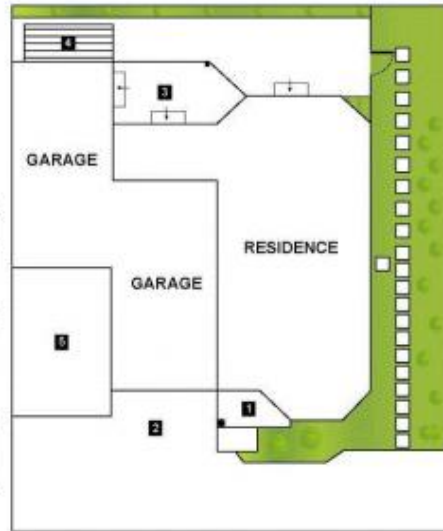

LEGEND

- 1. Porch
- 2. Driveway
- 3. Courtyard
- 4. Clothes Line
- 5. Car Parking

4/141 Cotlew St, ASHMORE

3 Car 3 Bed 2.5 Bath

Internal: 169m²
External: 34m²

Measurements are approximate and should not be relied upon.