

SOLD



2/22 Beatty Street, Southport

East facing and moments from the CBD, this contemporary Manhattan inspired town home (with a touch of industrial-chic) is packed full of features. One of just three? (all owner occupied), this is as big as a house without all of the maintenance.

Whether to live in, or add to your investment portfolio this flexible floor plan will delight the masses with its multiple living zones and generous proportions. If you are chasing proximity to Southport CBD, Gold Coast University Hospital, Australia Fair, Chirn Park, M1 and the Broadwater this address will also tick all boxes.

FEATURES...

...

3 3 2

Price: \$722,000

View: <https://remaxcoast.com.au/6697330>

Connie Elmer
M 0404413349



Kevin Brown

0417648001
RE/MAX Coast



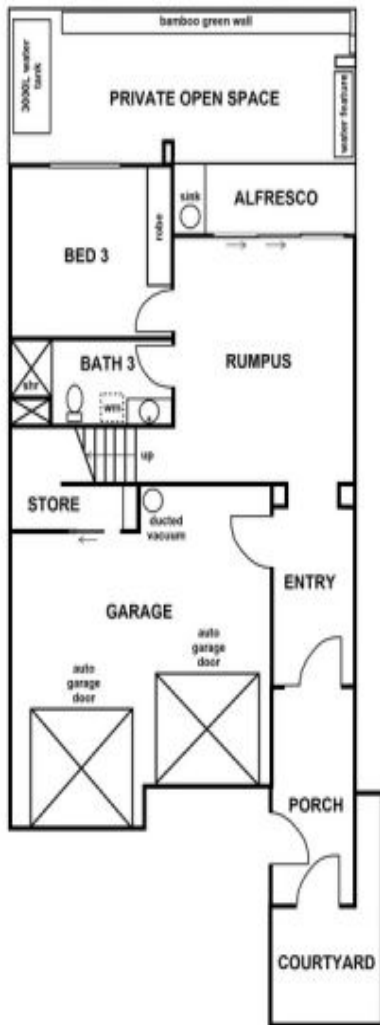

GROUND FLOOR

2/22 BEATTY STREET
SOUTHPORT



1ST FLOOR