

SOLD



3 Coastview Crescent, Tallai

SOLD BY KEVIN BROWN WITHIN THREE WEEKS. THE AVERAGE TIME ON MARKET IS 87 DAYS. Architecturally designed, fully landscaped and meticulously maintained, this executive Tallai acreage is your dream 'tree-change' property. Sensational panoramic views from every southern-facing window will rival any art piece in the home and with fabulous covered outdoor entertaining the view and fresh air can be enjoyed all year round. Perfectly north-facing and tucked within a quiet cul-de-sac, this home is located within a glorious part of Tallai surrounded by some of the suburbs most exclusive real estate. A world away from the hustle and bustle but still only minutes by car to Robina Town Centr...

4 2 3

Price: \$950,000
View: <https://remaxcoast.com.au/4970250>

Kevin Brown
M 0417648001



Lisa Brown
0407572235
 RE/MAX Coast



"Valley Views"

**3 COASTVIEW CRESCENT,
TALLAI 4213**

Land Size 5019m² or 1.24 Acres

Internal House Area 232m²
Garage Int'l Area 39m²
Combined 271m² or 29.1sqs

U/Cover Carport 22.2m²
Patio Areas 88.7m²
Pool Area 106.6m²
Shed 3.6 x 3.6/ 12.9m²
Water Tank

**Total Floor Area
501.4m² or 54sqs**

Ceiling Height
2.5m - 4.7m

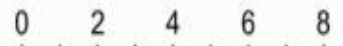

Gold Coast Floor Plans

Scale in Meters, Dimensions are approximate,
Whilst every care has been made we cannot
guarantee its 100% accuracy and interested
persons should rely on their own enquiries

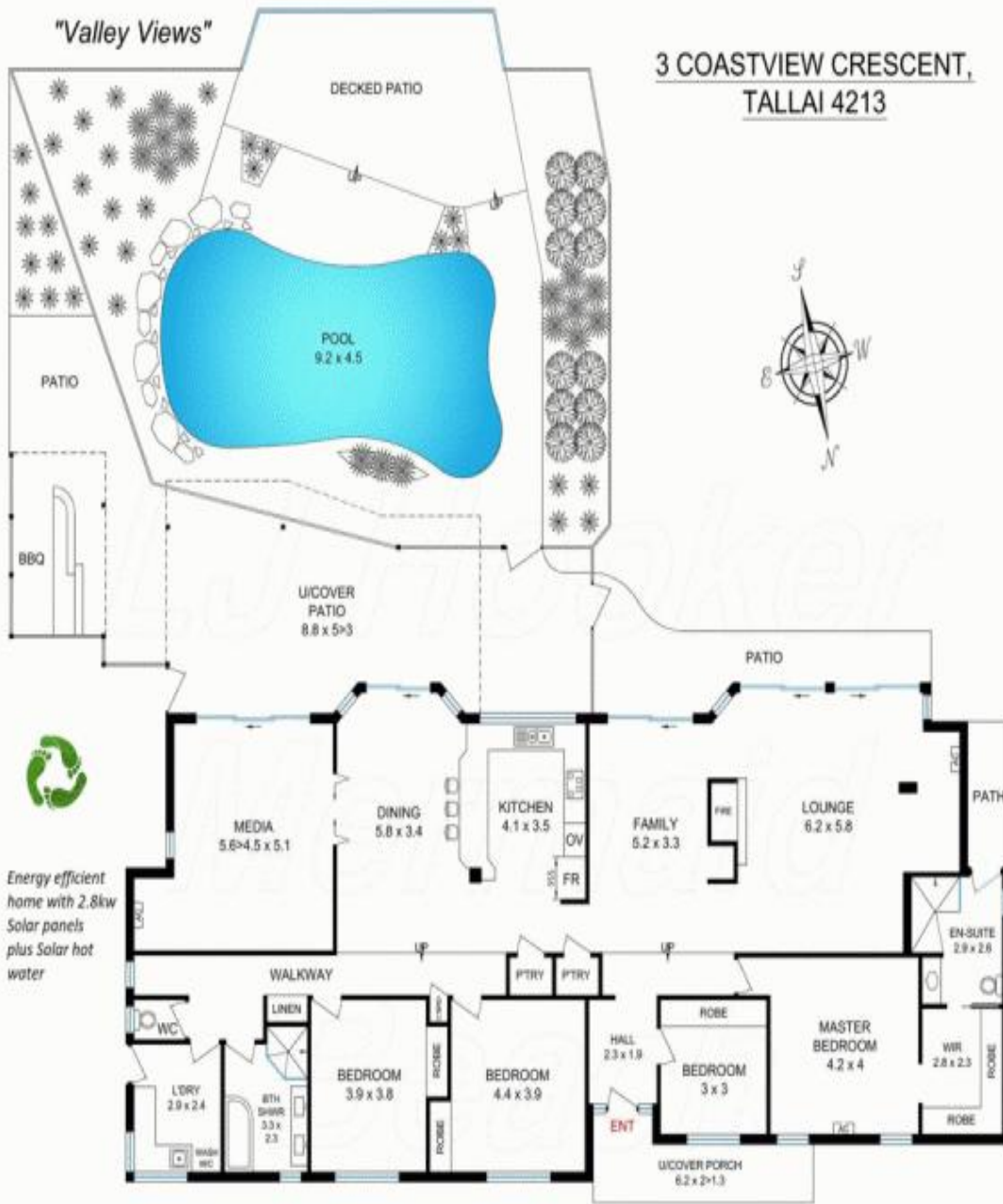

Energy efficient home with 2.8kw Solar panels plus Solar hot water